

Nature, Calme et Repos
Entre Mer et Montagne



Vos Vacances Vertes parmi
les Ecureuils et les Oiseaux

Mrs. Mr

Vence,

PACIFIQUE RESERVATION VOUCHER FOR MOBILE HOME

Please return completed, signed, form to us with your deposit

I would like to reserve a **mobile home Pacifique**,

FROM SATURDAY17h
TO SATURDAY9h30

Fixed deposit per week based on the current rates:

200€ Xweeks = 200.00 €
+ booking fee..... = 25.00 €

Total cost (including booking fee)..... =

RESERVATIONS MUST BE MADE BY:

I declare having received the booking conditions, in being familiarized with them, to accept and follow them.

Place Date "Read and approved" + SIGNATURE

- **PAYMENT BY BANKCARD** VISA-EUROCARD-MATERCARD-MAESTRO

card n° - - - - - EXP - - / - -

+ last **3 digits** on the back of your card - - -

Authorization to use the card: **DATE:** **SIGNATURE:**

- **TRANSFER:** IBAN FR76 1910 6006 0100 2756 8401 507
CODE BIC: AGRIFRPP891 – CREDIT AGRICOLE

Updated December 2020

1330 chemin de la Sine 06140 VENCE ☎0033 (0)4 93 58 09 36
www.camping-domainedelabergerie.com - info@camping-domainedelabergerie.com
Pour tout litige seul le tribunal de Grasse est compétent – RC GRASSE B 327015236

*Nature, Calme et Repos
Entre Mer et Montagne*



*Vos Vacances Vertes parmi
les Ecureuils et les Oiseaux*

GENERAL CONDITIONS FOR THE RESERVATION OF A MOBILE HOME

Mobile homes on sites 208 and 224 >5 years

Concerning the converted site of an equipped mobile home (electricity 10 Amp.):

Reservation is on a weekly basis (1 or more weeks), from SATURDAY (arrival between 17h and 19h) to SATURDAY (departure between 8h30 and 9h30 a.m.).

The **fixed deposit** for a mobile home reservation, as well as the booking fee, are payable upon reservation; the balance and security deposit are due upon arrival, before the distribution of keys. The booking fee (25€), due for an additional service, are not refundable. Booking fees offered if the whole stay is paid upon reservation. For any late (after 19.00) arrival and/or without reservation, file fees (25€) will be charged.

The security deposit will be refunded at the end of the stay if no degradation has occurred to the equipment and if the mobile home is properly cleaned.

The reservation will not be effective until the deposit has been collected, which must be received **within 7 days after reception of the reservation voucher. For all reservations made less than 15 days in advance, the totality of the payment is due by bankcard only.**

CANCELLATION IN THE EVENT OF JUSTIFIE FORCE MAJEURE:

More than 6 weeks before arrival, full reimbursement of the deposit for a mobile home.

Less than 6 weeks before arrival, no reimbursement.

Ask for the FFCC's cancellation insurance.

The arrival time is guaranteed for 24 hours, except with particular terms.

Animals are **PROHIBITED** for hygienic reasons.

The mobile home is intended for 2-4 persons, maximum, depending on the fee.

IMPORTANT:

THE BALANCE DUE ON THE RESERVATION OF A MOBILE HOME MUST BE PAID UPON ARRIVAL, as well as the SECURITY DEPOSITS 280 €(equipment and cleaning). They will be repaid the day you leave (200 €) deduction made for most or damage done; and (80 €) if the PACIFIQUE stays as cleaner as you get it, final cleaning made by yourself.

Any modification that may necessitate a change in charges must be signaled upon arrival.

For an earlier departure or later arrival, no repayment is possible. Once the stay has begun, no reimbursement is possible in the event of early departure, for any reason.

Clause conferring jurisdiction: any eventual litigation will be treated by the Tribunal of Grasse.

Dear Client,

These precisions are necessary to avoid any ambiguity. We thank you for your continued confidence and hope that you will enjoy your next vacation with us.

Updated December 2020

1330 chemin de la Sine 06140 VENCE ☎ 0033 (0)4 93 58 09 36
www.camping-domainedelabergerie.com - info@camping-domainedelabergerie.com
Pour tout litige seul le tribunal de Grasse est compétent – RC GRASSE B 327015236

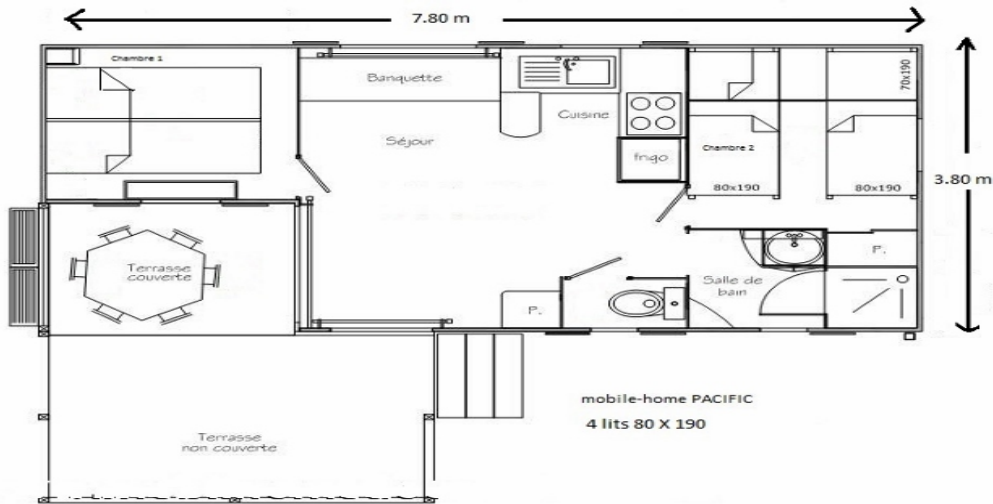

7,80 m X 3,80 m outdoor 30 m² + terrace m²

MOBILE HOME PACIFIQUE INVENTORY

ON PITCH 208 AND 224

- | | |
|-------------------------------|---------------------------------------|
| 6 PLATES ARCO | 1 WHITE PLASTIC CUTTING BOARD |
| 6 HALLOW PLATES ARCO | 1 WOODEN SPATULAS |
| 6 SMALL PLATES ARCO | 1 NYLON SKIMMER |
| 4 COFFEE CUPS ARCO | 1 NYLON LADLE |
| 4 STACKABLE MUGS ARCO | 1 TRAY ICE CUBE |
| 4 BOWLS ARCO | 1 FLOOR CLOTH |
| 4 EGG CUPS | 1 BUCKET 10 L |
| 1 SALAD BOW PIREX Ø 21 cm | 1 NYLON BROM |
| 1 SALAD BOWL ARCO Ø24 cm | 1 SMALL PLASTIC BROOM AND DUST SHOVEL |
| 1 ROUND HALLOW DISH Ø 28 cm | 1 WC BRUSH + WHITE HOLDER |
| 6 TURQUOISE GLASSES FOR WATER | 1 SQUARE PLASTIC BOWL 30 X 30 |
| 6 GLASSES FOR WINE | 6 PLASTIC HANGERS |
| 1 GLASS PITCHER | 1 PLASTIC DOORMAT |
| 6 INOX FORKS | 1 CLOTH DRYER + CLOTH PINS |
| 6 INOX BIG SPOONS | 1 CARBAGE CAN 15 L + LID |
| 6 INOX SMALL SPOONS | 1 WHITE ELECTRIC COFFEE MACHINE BOSCH |
| 6 KNIVES | 1 MICRO WAVE OVEN 20 L |
| 1 NON STICK FRYING PAN Ø28 cm | 1 COVER BELL FOR MICRO WAVE |
| 1 INOX SAUCEPAN Ø 12 cm | 1 TELEVISION + 1 REMOTE CONTROL |
| 1 INOX SAUCEPAN Ø 18 cm | |
| 1 INOX STEW POT + GLASS LID | WHITE PILLOWS 60 X 60 |
| 1 POTATO PEELER | UNDER PILLOW CASES |
| 1 COUTEAU OFFICE | BLANKETS FOR 1 PERSON BED(80 X 190) |
| 1 SALAD SET | BLANKET FOR 2 PERSONS BED 140 X 190 |
| 1 MELANINE TABLE MAT Ø 19 cm | 4 PLASTIFIED UNDER SHEET 80 X 190 |
| 1 PLASTIC COLANDER Ø 26 cm | 4 BED MOLLETONS 80X190 |
| 1 USTENSIL BASKET 5 CASES | |
| 1 TIN OPENER | |
| 1 TIRE CAP AND BOTTLE-OPENER | |
| SHEETS AND LINEN AND | |
| TOWELS ARE NOT INCLUDED | |

ON DEMAND

- | | |
|--------------------------|------|
| SHEETS TO RENT /person | 8 € |
| TOWELS TO RENT /person | 6 € |
| DISPOSABLE SHEETS/person | 5 € |
| FINAL CLEANING | 80 € |

PLEIN-AIR 4 PERSONNES

- 2 TAUPE ARMCHAIR SUNBATHING
- 1 GREEN OUTDOOR TABLE 140 X 90
- 4 GREEN OUTDOOR CHAIRS

A LE

Precede the reference signature READ AND APPROVED

Camping du Domaine de la Bergerie ***

Côte d'Azur France

www.camping-domainedelabergerie.com

MOBIL HOME RENTAL PACIFIQUE

Available 2, >5 years

TARIF 2021

Excluding Tourist Tax*

			WEEK	Night mini 3 <7 N	Extra Night > 7 N	Extra people per Night
PACIFIQUE 25 m ²	MARCH-APRIL-OCTOBER	2 Persons	320 €	55€	45 €	8.00 €
	MAI-JUNE-SEPTEMBER	2 Persons	410 €	70 €	60 €	10.00 €
	SAISON JULY- AUGUST	4 Persons	720 €	125 €	110 €	--

***TAX FOR VENCE CITY: 0, 40 €/night/people or child over 18 year**

This set price includes the pitch + 1 car or 2 motorbikes + 2 (or 4 = depends on the date) people + water + electricity.

Rental for a week, from SATURDAY between 5 and 7 PM, to SATURDAY between 8.30 and 9.30 am

For one more car or trailer, you must pay the exact fees of the campsite.

BOOKING OR SUPPORT FEES: 25 €

(FEES OFFERED IF TOTAL PAYMENT ON BOOKING)

200€ down payment for booking + 25 € booking fees

Payment: visa card, master card or transfer, and you must pay the balance the day of your arrival + Tourist tax (for Vence City).

For any late (after 19.00) arrival and/or without reservation, file fees (25€) will be charged

For an earlier departure or later arrival, no repayment

DEPOSIT: 280€

200 € + 80 € for the cleaning = **280 €** paid the day of your arrival. They will be repaid (200 €) the day you leave, if nothing is lost or damaged, and (80 €) if the Mobil home stays as cleaner as you get it (final cleaning done by yourself).

PETS ARE FORBIDDEN

Renting Bed linen: 8 €/person on demand when booking

Renting towels: 6€/person on demand when booking

Disposable sheets: 5€/person

Final Cleaning: 80 €

All the lodgers benefit by all the campsite facilities: free access to the swimming pool (respect its rules), Tennis Court (price at the office), playground, fitness area, laundry (tokens at the office)...

Please tell us on booking how many people you will be and for children how old they are.

DISCOUNT LOW SEASON:

- * 2 weeks -10 %
- * 3 weeks -15 %
- * 4 weeks -20 %

From the 25th of March to the 15th of October

Front desk open Hours 9H 12H30 /15H 19H

Updated December 2020

1330 Chemin de la Sine - 06140 VENCE - ☎ 0033(0)4 93 58 09 36

info@camping-domainedelabergerie.com

Pour tout litige seul le tribunal de Grasse est compétent – RC GRASSE B 327015236