



Mr. Mrs.

Vence,

## RESERVATION VOUCHER FOR MOBILE HOME

Please return completed, signed, form to us with your deposit

I would like to reserve a “Riviera” mobile home

FROM..... 5 - 7 pm  
TO ..... 8.30 - 9.30 am

Fixed deposit per week based on the current rates:

200€ X .....weeks = ..... €  
+ booking fee..... = 25.00 €  
**Total cost (including booking fee)..... =.....€**

RESERVATION MUST BE MADE BY:

**I declare having received the booking conditions, being familiarized with them, to accept and follow them.**

Place                      Date                      “Read and approved” + SIGNATURE

- **Payment by bankcard:** VISA-EUROCARD-MATERCARD-MAESTRO

card n° - - - - - EXP - - / - -

+ last **3 digits** on the back of your card - - -

Authorization to use the card:              **DATE:**                      **SIGNATURE:**

- **TRANSFER:** IBAN FR76 1910 6006 0100 2756 8401 507  
CODE BIC AGRIFRPP891 – CREDIT AGRICOLE



## GENERAL CONDITIONS FOR THE RESERVATION OF A RIVIERA MOBILEHOME

Mobile home on site 65C, < 5 years old

Concerning the converted site of an equipped mobile home (electricity 10 Amp.):

Reservation is on a weekly basis (1 or more weeks), arrival between 5 and 7 pm, departure between 8.30 and 09.30 am).

The FIXED deposit for a mobile home reservation, as well as the booking fee, are payable upon reservation; the balance and security deposit are due upon arrival, before the distribution of keys.

The booking fee (25€) and the deposit, due for an additional service, are not refundable. Booking fee offered if the whole stay (with Tourist Taxes) is paid upon reservation.

For any late (after 7 pm) arrival and/or without reservation, file fees (25€) will be charged.

The security deposit will be refunded at the end of the stay if no degradation has occurred to the equipment and if the mobile home is properly cleaned.

The reservation will not be effective until the deposit has been collected, which must be received **within 7 days** after reception of the reservation voucher. **For all reservations made less than 15 days in advance, the totality of the payment is due by bankcard only, offer valid for 48 hours.**

### **CANCELLATION IN THE EVENT OF JUSTIFIED FORCE MAJEURE:**

More than 6 weeks before arrival: full reimbursement of the deposit for a mobile home, less processing fee (25€).

Less than 6 weeks before arrival: no reimbursement.

Ask for the FFCC's cancellation insurance.

The arrival time is guaranteed for 24 hours, except with particular terms.

Animals are PROHIBITED for hygienic reasons.

The mobile home is intended for 2-4 persons, maximum, depending on the fee.

### **IMPORTANT:**

**THE BALANCE DUE ON THE RESERVATION OF A MOBILE HOME MUST BE PAID UPON ARRIVAL, as well as the SECURITY DEPOSITS 280 €** (equipment and cleaning). They will be repaid the day you leave: 200 € if nothing is lost or damaged, and 80 € if the Malaga is as clean as on your arrival, final cleaning done by yourself. At last the day before you are leaving, you have to ask for an appointment for the leaving inventory.

Any modification that may necessitate a change in charges must be signaled upon arrival. For an earlier departure or later arrival, no repayment is possible, for any reason.

It is prohibited to recharge any electric vehicle in the campsite. Our campsite is not equipped with charging stations.

Clause conferring jurisdiction: any eventual litigation will be treated by the Tribunal of Grasse.

Dear Client,

These precisions are necessary to avoid any ambiguity. We thank you for your continued trust and hope that you will enjoy your next vacation with us.

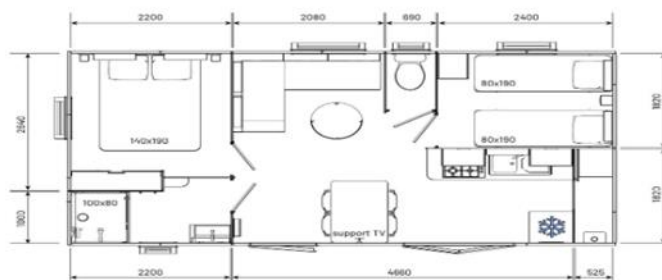

## RIVIERA MOBILE HOME INVENTORY

ON PITCH 65C

8,45 m X 4 m interior 29 m<sup>2</sup> + terrace 20 m<sup>2</sup>

- |  |  |
|--|--|
| 6 PLATES                               | 1 PLASTIC CUTTING BOARD                            |
| 6 HALLOW PLATES                        | 1 UNIVERSAL LID                                    |
| 6 SMALL PLATES                         | 1 WOODEN SPATULAS                                  |
| 4 COFFEE CUPS                          | 1 NYLON SKIMMER                                    |
| 4 STACKABLE MUGS                       | 1 NYLON LADLE                                      |
| 4 BOWLS                                | 1 SCISSORS   |
| 4 EGG CUPS                             | 1 TRAY ICE CUBE                                    |
| 1 SALAD BOW PIREX Ø 21 cm              | 1 FLOOR CLOTH                                      |
| 1 SALAD BOWL ARCO Ø 24 cm              | 1 BUCKET 10 L                                      |
| 1ROUND HALLOW DISH Ø 28 cm             | 1 NYLON BROOM                                      |
| 6 GLASSES FOR WATER                    | 1 SMALL PLASTIC BROOM AND DUST SHOVEL              |
| 6 GLASSES FOR WINE                     | 1 WC BRUSH + HOLDER                                |
| 1 GLASS PITCHER                        | 1 SQUARE PLASTIC BOWL 30 X 30                      |
| 6 INOX FORKS                           | 6 PLASTIC HANGERS                                  |
| 6 INOX BIG SPOONS                      | 1 PLASTIC DOORMAT                                  |
| 6 INOX SMALL SPOONS                    | 1 CLOTH DRYER + CLOTH PINS                         |
| 6 KNIVES                               | 1 CARBAGE CAN 15 L + LID                           |
| 1 FRYING PAN Ø 28 cm                   | 1 TOASTER  |
| 1 STEEL SAUCEPAN Ø 12 cm               | 1 GRATER   |
| 1 STEEL SAUCEPAN Ø 18 cm               | 1 WHITE ELECTRIC COFFEE MACHINE BOSCH              |
| 1 INOX STEW POT + GLASS LID            | 1 MICRO WAVE OVEN 20 L+1 COVER BELL FOR MICRO WAVE |
| 1 POTATO PEELER                        | 1 TELEVISION + 1 REMOTE CONTROL                    |
| 1 COUTEAU OFFICE                       | 4 WHITE PILLOWS 60 X 60                            |
| 1 SALAD SET                            | 4 UNDER PILLOW CASES                               |
| 1 TABLE MAT                            | POLAIRE BLANKETS FOR 1 PERSON BED (80 X 190)       |
| 1 PLASTIC COLANDER Ø 26 cm             | POLAIRE BLANKET FOR 2 PERSONS BED (140 X 190)      |
| 1 USTENSIL BASKET 5 CASES              | 2 PLASTIFIED +2 COTTON UNDER SHEETS 80 X 190       |
| 1 TIN OPENER                           | 1 PLASTIFIED +1 COTTON UNDER SHEET 140 X 190       |
| 1 TIRE CAP AND BOTTLE-OPENER           |  |
| 1 ROUND CASSEPOLE DISH & LID           |  |
| 1 KETTLE                               |  |
| <u>TO RENT ON DEMAND WHEN BOOKING:</u> | <u>PLEIN-AIR 4 PERSONNES</u>                       |
| BED LINEN /PERSON <b>15 €</b>          | 2 ARMCHAIR SUNBATHING WITH BACK ADJUSTABLE         |
| TOWELS /PERSON <b>8 €</b>              | 1 OUTDOOR TABLE 140 X 90                           |
| DISPOSABLE SHEETS/PERSON <b>6 €</b>    | 4 OUTDOOR CHAIRS +2 ARMCHAIRS +LITTLE TABLE        |
| CLEANING FEE <b>80 €</b>               |  |
| BABY KIT <b>50 €</b>                   | Place .....Date                                    |
| 1 UMBRELLA BABY BED 60 X 120           | .....  |
| 1 MATRESSS + 1 UNDER SHEET             | Signature to be preceded by the mention "READ AND  |
| 1 BABY FITTED SHEET                    | APPROVED"  |
| Bed linen and towels are not included  |  |



# MOBIL HOME RENTAL RIVIERA

1 Available < 5 years

## PRICES 2025

Excluding Tourist taxes \*

			Week	Nuit mini 3 < 7 N	Nuit sup > 7 N
<b>RIVIERA</b> 29 m²	<b>LOW SEASON*</b>	4 persons	<b>550 €</b>	<b>100 €</b>	<b>90 €</b>
	<b>SEASON 07.12-08.22.2025</b>	4 persons	<b>980 €</b>	<b>190 €</b>	<b>150 €</b>

**\*TOURIST TAXES:** 0, 80 € /night/ person over 18 years

**\*LOW SEASON:** 25 March – 11 July and 23 August - 15 October 2025

This set price includes the pitch + 1 car or 2 motorbikes + 4 people + water + electricity 10A.

Rental per week, arrival between 5 and 7 pm, departure between 8.30 and 9.30am.

For one more car or trailer, you must pay the exact fees.

**BOOKING OR SUPPORT FEES:** 25 €

FEES OFFERED IF TOTAL PAYMENT ON BOOKING

200 €/week booked + 25 € files fees

Payment: visa card, master card or transfer, and the balance must be paid the day of your arrival + tourist taxes.

For any late (after 7pm) arrival and/or without reservation, file fees (25€) will be charged

For an earlier departure or later arrival, no repayment.

**DEPOSIT:** 280 €

200 € + 80 € for the cleaning = 280 € paid the day of your arrival. They will be repaid (200 €) the day you leave, if nothing is lost or damaged, and 80 € if the mobile home is as clean as on your arrival (final cleaning done by yourself). At last the day before you are leaving, you have to ask for an appointment for the leaving inventory.

**PETS ARE FORBIDDEN**

**LINEN RENTAL:** 15 €/person on demand when booking

**TOWELS RENTAL:** 8 €/person on demand when booking

**DISPOSABLE SHEETS:** 6 €/person on demand when booking

**FINAL CLEANING:** 80 €

All the lodgers benefit from all the campsite facilities: free access to the swimming pool (respect its rules), Tennis Court (price at the office), playground, fitness area, laundry (tokens at the office)...

As soon as possible, please tell us your date from Saturday to Saturday and the number you will be (adults and children)

**DISCOUNT LOW SEASON:**

- \* 2 weeks -10 %
- \* 3 weeks -15 %
- \* 4 weeks -20 %

**DISCOUNT SEASON:**

- \* 4 weeks -15 %